

ARMSTRONG - STEAM & ENGINEERING

FROM CONCEPT TO CONCLUSION

PRODUCT DATA SHEET

PRODUCT # SEP-088

ISSUED 2/99

DESCRIPTION

BRONZE SIGHT GLASS. SUITABLE FOR STEAM TRAP DISCHARGE OR OTHER LOW PRESSURE APPLICATIONS.

COLD WORKING PRESSURE : 700 KPA

SATURATED STEAM PRESSURE : 350 KPA

MAX TEMPERATURE :

150 DEG C

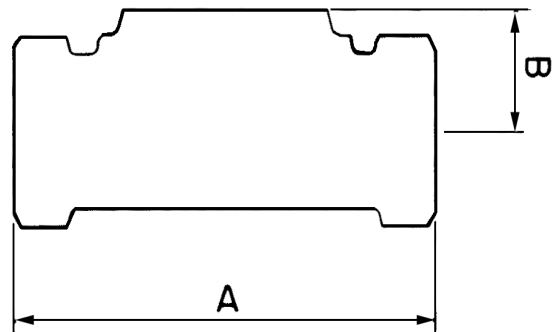

SIZE	A	B	DN	CV	KG	PART NAME	MATERIAL	OPTIONAL
15	85	25	15		0.5			
20	98	29	20		0.6	BODY	BRONZE	
25	114	31	25		0.9	CAP	BRONZE	
32	130	37	32		1.2	GLASS	HARDENED	
40	140	38	40		1.5	GASKET	NON-ASBESTOS	
50	155	47	50		2.2			

ALL DIMENSIONS ARE IN MM AND ARE APPROXIMATE ONLY IF CRITICAL PLEASE CONFIRM